

# EXCHANGER XK TYPE

A tubular bundle in a  
parallelepiped shape for  
charged fluids



- Compact
- Easy mechanical cleaning
- 2 doors
- Robust and reliable

- Tubes are welded to the tubular plate sheet like a standard multi-tube exchanger
- One circuit is fully welded
- The other circuit offers a full accessibility to the exchange surface.

## Construction principle:

A parallelepipedal bundle is inserted into a welded frame.

Tube side is equipped with 2 doors providing access to the entire transfer area.

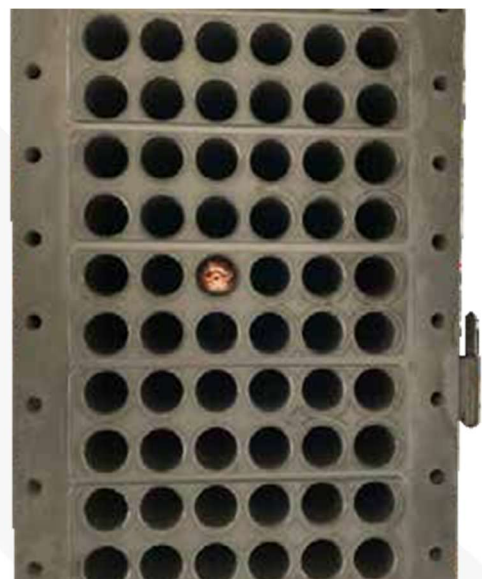



Fully made of stainless steel or Duplex  
For heating or cooling waste water, sludges and charged fluids

Easy opening of doors  
without removing the pipes  
Doors on hinge in option

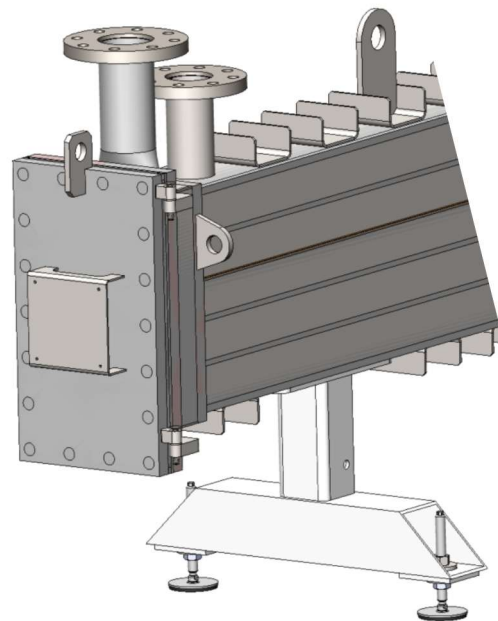

## Criteria for performance :

- Compact design
- Maximum pressure 15 bars
- Maximum temperature maximum 150° C
- Exchange area up to 150 m<sup>2</sup> in one single module
- Mechanical cleaning on 1 circuit
- Tubes diameters from 42 mm to 89 mm
- All welds can be inspected
- Designed according to CODAP and Sound Engineering Practice
- Manufactured in stainless steel, duplex
- CE marking according to European norms (PED 2014/68/EU)